

# Make Your City Smart

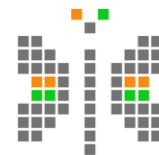

**Smart City**  
MISSION TRANSFORM-NATION

## **Existing Situation Report Vir Bhagat Singh Garden, Surat**

**Surat Smart City Limited**

**Surat, Gujarat**

**September, 2016**

## Table of Contents

<b>1. Introduction.....</b>	<b>3</b>
<b>2. Facts about the Park .....</b>	<b>3</b>
<b>3. Annexure 1: Map of Existing Feature.....</b>	<b>6</b>
<b>4. Annexure 2: Picture Gallery of Existing Features.....</b>	<b>7</b>

# VIR BHAGAT SINGH GARDEN, SURAT

## 1. INTRODUCTION

Vir Bhagat Singh Garden is located on Tikam Nagar Road, it lies in East zone, Umar Wada Mata Wadi ward. The Area of the park is 6400 sqm. The park has two entry and exits points. It is a Neighbourhood Park and caters to around 1.5 Lakhs persons. It is active park as several activities can be seen happening in the park.

The park has huge Kids play set area and as well as exercising machines for adults.

## 2. FACTS ABOUT THE STREET

Some of the salient notable facts in this street is given in table mentioned below:

Features	Status as on Date
<b>Category of Park</b>	Neighborhood Park
<b>Total Area(in.sq.m)</b>	6400 sq.mtrs
<b>Neighboring Streets</b>	Tikam Nagar Road
<b>Catchment Population of the Park</b>	The catchment population of park is around 1.5 lacs
<b>General Condition</b>	The park is Flat and with fair level of cleanliness (ref. photo no. 4, 9, 11, 12)
<b>Open Green Space Landscaped Area</b>	The condition of the open Green space is quite fair, clean and almost flat. ( ref. photo no. 7, 11, 12)
<b>Flower Variety</b>	There are few variety of flowers, but no markers are provided. ( ref. photo no 2, 8)
<b>Shrubs &amp; Bushes</b>	There are few shrubs and bushes with colours.
<b>Wooded Area</b>	There is a flat wooded area in the park .Although the wooded area is not dense.
<b>Paved Pathways</b>	The pathway provided is in good condition around 6 Mtrs and 3 mtrs (the internal pathway) Few benches are provided along the pathway and is free from obstructions
<b>Water Areas</b>	Not available
<b>Eating Features</b>	There is an eating Kiosk outside the park.
<b>Drinking Features</b>	There is only one drinking feature.
<b>Facilities</b>	<b>Boundary wall:</b> The boundary wall is hybrid type having brick wall and grill over it. ( ref. photo no. 17, 24, 19)
	<b>Entry Gate:</b> The park has 2 metallic gates. ( ref. photo no. 15,1)
	<b>Recreational Centre:</b> No availability of Recreational Centre
	<b>Illumination In Park:</b> The park High

	mass lights. ( <i>ref. photo no 18, 13</i> )
	<b>Public Convenience:</b> There is one washroom.
	<b>Parking:</b> There is no designated parking space. The car are parked outside the park along the road
	<b>Dustbins:</b> There is a provision of dustbins; the number of dustbins is 6 ( <i>ref. photo no. 6, 23</i> )
	<b>Signboards:</b> Few signboards are provided at certain location
	<b>Rain water Harvesting:</b> There is a provision for rain water harvesting. ( <i>ref. photo no. 16</i> )
<b>Sitting or Resting Features</b>	<b>Benches:</b> The park has 70 cement concrete benches and are in good condition. ( <i>ref. photo no. 7, 4, 12</i> )
	<b>Table:</b> There are no availability of Picnic Table
	<b>Shelter/ Hut:</b> There is availability of hut
<b>Play Set/ Structure</b>	<p>There is availability of play sets  No of structures:  Slide down structures 6  Hanging structures : 4  Things to climb on, up or through: 4  Swinging structures : 6  Spring toys : 0</p> <p>The soil is loose. There is ample of Openness. There is availability of seating structures and has 33% shaded area with fair condition. The play area has proper lighting.</p> <p><b>Slide down structures:</b>  The structure has <b>4</b> straight slides  <b>1</b> Curve slide  <b>1</b> Tube slides  Poles  Pole slides  Height of ground to top of sliding surface less than 5 ft</p> <p>Hanging structures</p>

	<p>2 movable rings are present, made out of metal and height off ground is 4 ft</p> <p>Things to climb on, up or through</p> <p>Swinging structures: There are 6 swinging structures, with average height of less than 2 feet.</p> <p>Spring toys: There is no availability of animal spring toys</p>
<b>Play Area</b>	There is small play area for kids ( <i>ref. photo no. 20</i> )
<b>Features for differently abled</b>	No provision for differently abled

# ANNEXURE: 1

Annexure 1: Map of Existing Features

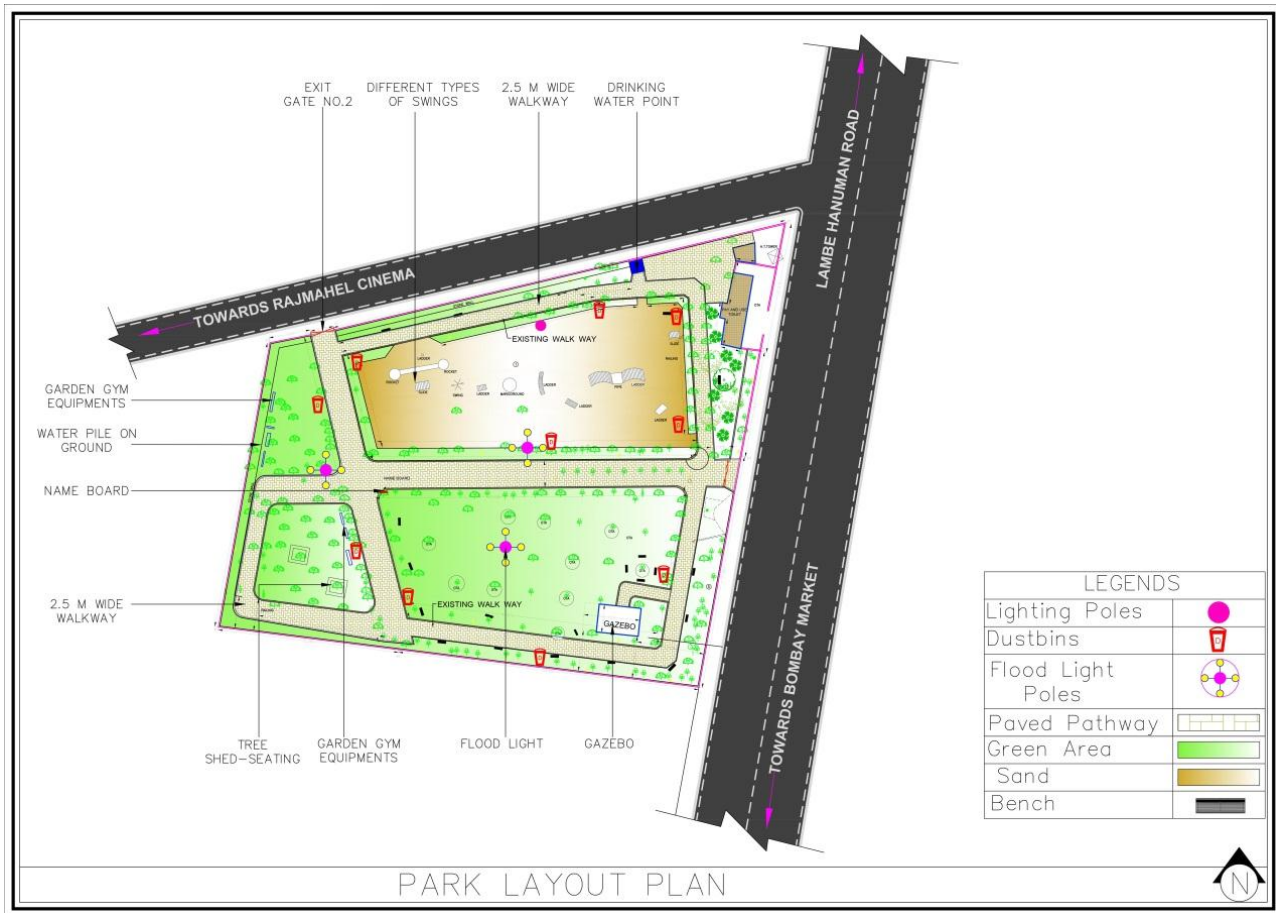

# ANNEXURE: 2

## Annexure 2: Picture Gallery of Existing Condition

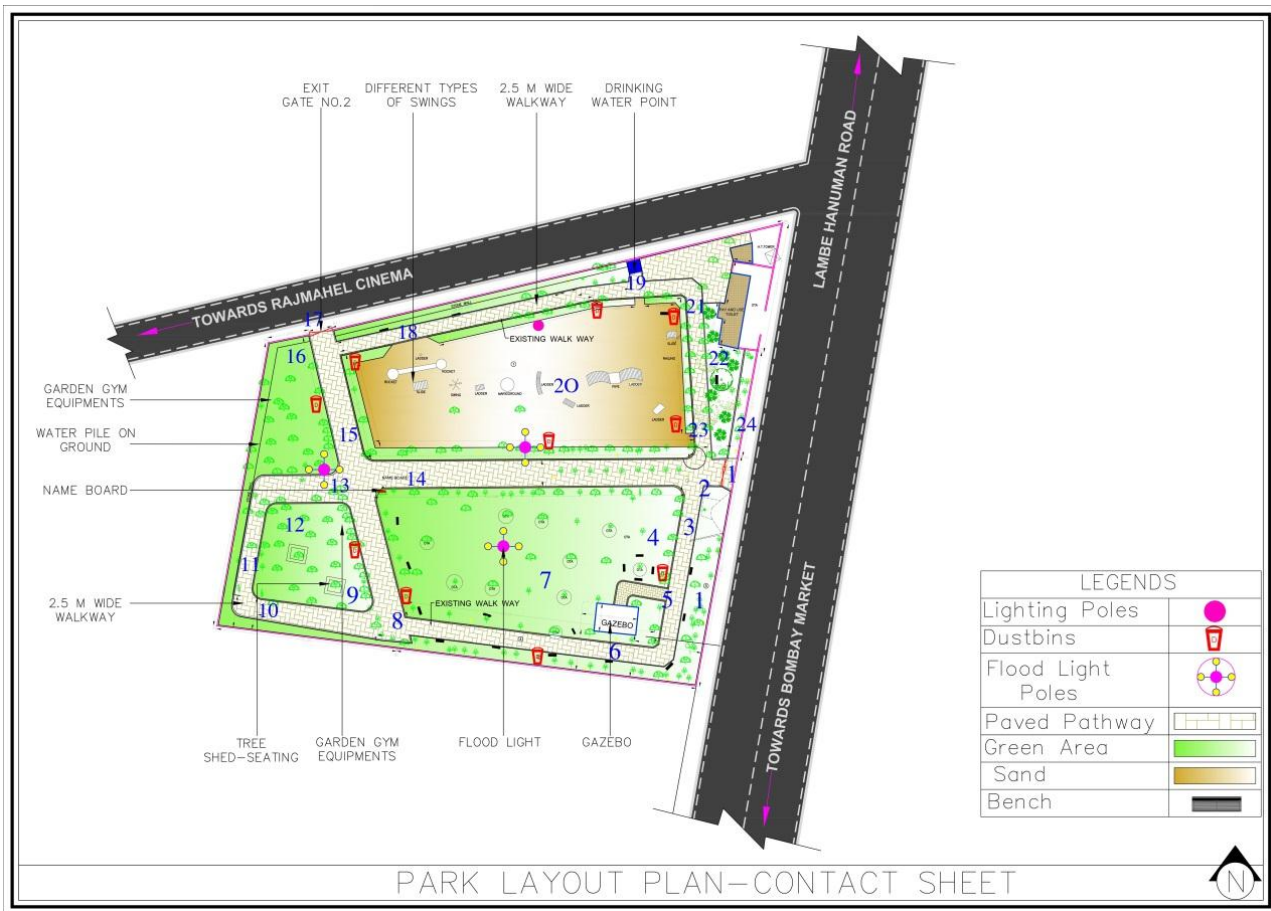

## ANNEXURE: 2



01-MAIN ENTRANCE TO PARK.jpg



02-EXISTING CARE TAKER ROOM.jpg

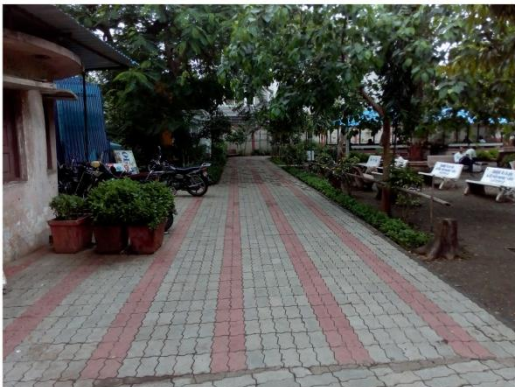

03-CONDITION OF WALKWAY.jpg



04-SITTING AREA IN PARK.jpg



05-PLANTERS.jpg

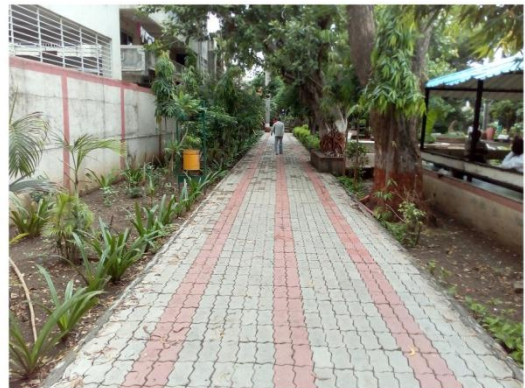

06-CONDITION OF DUSTBINS.jpg



07-CONDITION OF BENCH AND DRAIN.jpg



08-SHADED WALKWAY.jpg



## ANNEXURE: 2



09-EXISTING CONDITION.jpg



10-CONDITION OF BOUNDARY WALL.jpg



11-OBSTRUCTED WALKWAY.jpg



12-CONDITION OF BENCH AND EXERCISE EQUIPMENTS.jpg



13-CONDITION OF EXISTING FLOOD LIGHT.jpg



14-SHADED WALKWAYS.jpg



15-SECONDARY ENTRANCE GATE OF PARK.jpg



16-EXISTING RAIN WATER HARVESTING CONDITION.jpg

## ANNEXURE: 2



17-PARKING AT SECONDARY ENTRANCE GATE.jpg



18-ELECTRIC LIGHT POLE.jpg



19-CONDITION OF DRINKING WATER FACILITY.jpg



20-PLAY AREA.jpg

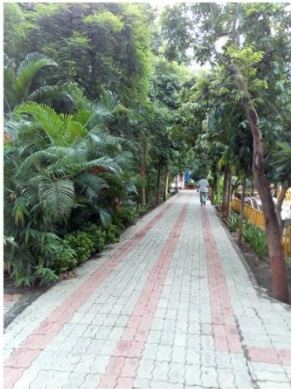

21-SHADED WALKWAY.jpg



22-UNIQUE TREE.jpg



23-ACCESS TO PLAY AREA.jpg



24-ENCROACHED FOOTPATH AT MAIN ENTRANCE.jpg